

- NOTES
- 1) ALL DIMENSIONS ARE IN METRES UNLESS OTHERWISE STATED.
  - 2) DO NOT SCALE FROM THIS DRAWING.
  - 3) THIS IS A DRAFT WORK IN PROGRESS DRAWING. FURTHER CHANGES ARE LIKELY TO THE DESIGN.
  - 4) THE ROAD MARKINGS ON THIS DRAWING ARE FOR ILLUSTRATION PURPOSES ONLY.

KEY

	PROPOSED INDICATIVE KERBLINE
	EXISTING LAYOUT
	PROPOSED ROAD MARKINGS
	INDICATIVE EXISTING HIGHWAY BOUNDARY
	PROPOSED VERGE
	PROPOSED HARD SHOULDER
	EXISTING CATEGORY 'A' TREES
	DIRECTION OF EMBANKMENT
	PROPOSED PRIMARY SIGNAL POLE
	PROPOSED SECONDARY SIGNAL POLE
	PROPOSED CONTROLLED TACTILES
	PROPOSED SHARED FOOTWAY/CYCLEWAY
	PROPOSED POND
	PROPOSED NATIVE MIX PLANTING (WHIPS)
	PROPOSED WOODLAND MIX PLANTING (VARIETY OF SIZES)
	EXISTING PEDESTRIAN RIGHT OF WAY
	INDICATIVE LOCATION OF NEW HIGHWAY BOUNDARY
	ADDITIONAL LAND REQUIRED FOR CONSTRUCTION

ISSUE/REVISION

I/R	DATE	DESCRIPTION
2	17/12/2020	FURHTER OCC COMMENTS
1	30/11/2020	FOLLOWING OCC COMMENTS
0	28/10/2020	FEASIBILITY DESIGN

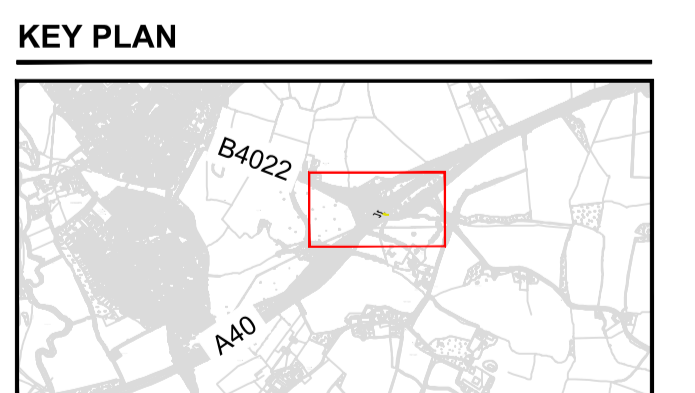

PROJECT NUMBER  
60611611

SHEET TITLE  
ACCESS TO WITNEY  
FEASIBILITY STUDY - OPTION 2A-G  
SHEET 1 OF 1

SHEET NUMBER  
60611611-ACM-XX-XX-DR-HW-000015

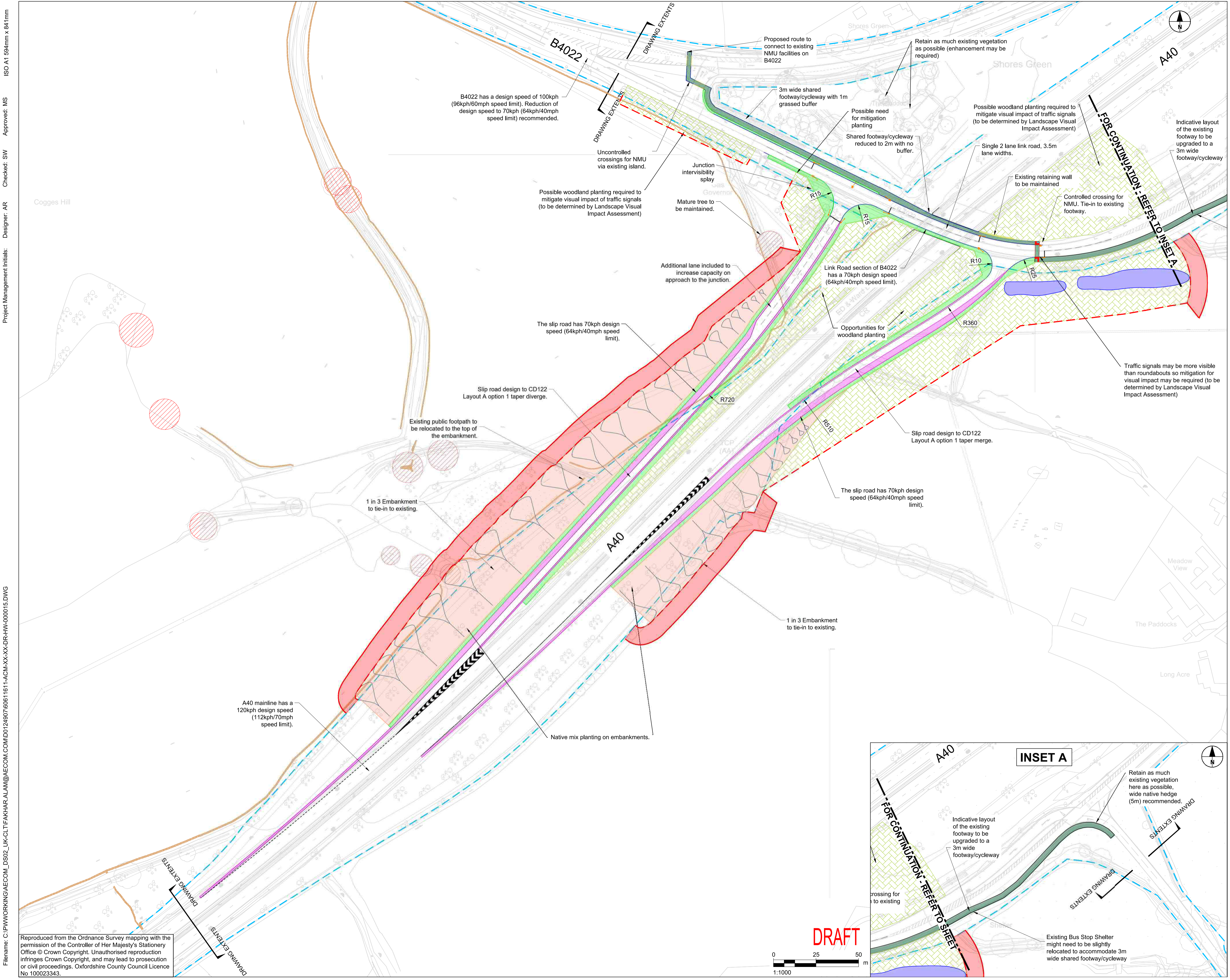

**DRAFT**



ISO A1 594mm x 841mm  
Approved: MS  
Checked: SW  
Designer: AR  
Project Management Initials:  
File name: C:\P\WORKING\AECOM\_DS02\_UK-CLT\FAK\HAR\ALAM\AECOM\COM\ID012490760611611-ACM-XX-XX-DR-HW-000015.DWG  
Reproduced from the Ordnance Survey mapping with the permission of the Controller of Her Majesty's Stationery Office © Crown Copyright. Unauthorised reproduction infringes Crown Copyright, and may lead to prosecution or civil proceedings. Oxfordshire County Council Licence No 100023343.  
Printed on 100% Post-Consumer Recycled Content Paper